

EF MANŞON EF COUPLER ЭЛ.СВАРНАЯ МУФТА

Elektrofüzyon / Electrofusion / Material:PE100 / Standart: TS EN 1555-3:2010 + A 1 • TS EN 12201-3 + A 1

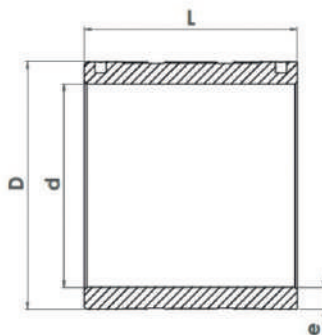
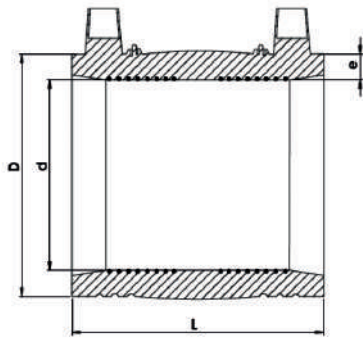

d	Article No	Bar	D	L	e	Weight (kg)	Pack (pc)
Ø20	MN001600002014	PN16	31	68	2,0	0,035	120
Ø25	MN001600002514	PN16	36	71	2,3	0,040	120
Ø32	MN001600003214	PN16	45	79	3,0	0,050	100
Ø40	MN001600004014	PN16	53	80	3,7	0,080	80
Ø50	MN001600005014	PN16	67	89	4,6	0,120	60
Ø63	MN001600006314	PN16	82	97	5,8	0,200	40
Ø75	MN001600007514	PN16	95	98	6,8	0,275	25
Ø90	MN001600009014	PN16	116	114	8,2	0,400	12
Ø110	MN001600011014	PN16	138	146	10,0	0,700	16
Ø125	MN001600012514	PN16	153	150	11,4	1,050	12
Ø140	MN001600014014	PN16	177	162	12,7	1,450	10
Ø160	MN001600016014	PN16	200	178	14,6	1,850	4
Ø180	MN001000018014	PN10	218	192	10,7	1,700	4
	MN001600018014	PN16	221	192	16,4	2,350	4
Ø200	MN001000020014	PN10	233	213	11,9	2,280	3
	MN001600020014	PN16	246	216	18,2	3,300	3
Ø225	MN001000022514	PN10	257	235	13,4	2,650	1
	MN001600022514	PN16	267	230	20,5	3,850	1
Ø250	MN001000025014	PN10	287	245	14,8	3,650	1
	MN001600025014	PN16	309	230	22,7	5,650	1
Ø280	MN001000028014	PN10	339	250	16,6	6,570	1
	MN001600028014	PN16	339	250	25,4	6,950	1
Ø315	MN001000031514	PN10	361	256	18,7	5,990	1
	MN001600031514	PN16	380	251	28,6	8,550	1
Ø355	MN001000035514	PN10	400	272	21,1	7,250	1
	MN001600035514	PN16	422	272	32,2	10,650	1
Ø400	MN001000040014	PN10	454	271	23,7	9,670	1
	MN001600040014	PN16	483	271	36,3	15,250	1
Ø450	MN001000045014	PN10	510	327	26,7	16,500	1
	MN001600045014	PN16	527	327	40,9	23,500	1
Ø500	MN001000050014	PN10	565	320	29,7	16,500	1
	MN001600050014	PN16	615	350	45,4	29,258	1
Ø560	MN001000056014	PN10	640	350	33,2	24,600	1
	MN001600056014	PN16	685	350	50,8	38,360	1
Ø630	MN001000063014	PN10	720	360	37,4	29,500	1
	MN001600063014	PN16	780	360	57,2	54,300	1
Ø710	MN001000071014	PN10	810	380	42,1	38,500	1
	MN001600071014	PN16	880	380	64,5	68,500	1
Ø800	MN001000080014	PN10	910	400	47,4	60,000	1
	MN001600080014	PN16	980	400	72,6	89,000	1
Ø900	MN001000090014	PN10	1025	450	53,3	80,000	1
	MN001600090014	PN16	1105	450	81,7	130,000	1
Ø1000	MN001000100014	PN10	1140	500	59,3	111,500	1
	MN001600100014	PN16	1225	500	90,8	165,000	1
Ø1200	MN001000120014	PN10	1370	500	71,1	161,000	1
	MN001600120014	PN16	1450	500	109,1	245,000	1
Ø1400	MN001000140014	PN10	1600	550	83,0	243,000	1
	MN001600140014	PN16	1700	550	127,3	380,000	1
Ø1600	MN001000160014	PN10	1830	575	94,8	336,000	1
	MN001600160014	PN16	1900	575	145,5	448,000	1

EF DİRSEK 45° EF ELBOW 45° ЭФ ОТВОД 45°

Elektrofüzyon / Electrofusion / Material:PE100 / Standart: TS EN 1555-3:2010 + A1 • TS EN 12201-3 + A1

d	Article No	Bar	d1	L	L1	Z	Weight (kg)	Pack (pc)
*Ø32	DR451600003217	PN16	44	119	32	87	0,154	1
Ø40	DR451600004014	PN16	54	52	42	10	0,105	1
Ø50	DR451600005014	PN16	67	58	45	13	0,170	1
Ø63	DR451600006314	PN16	81	67	49	18	0,245	1
Ø75	DR451600007514	PN16	94	83	62	21	0,433	1
Ø90	DR451600009014	PN16	114	90	64	26	0,655	1
Ø110	DR451600011014	PN16	138	108	78	30	1,155	1
Ø125	DR451600012514	PN16	153	109	77	32	1,255	1
*Ø125	DR451600014017	PN16	163	213	83	130	3,205	1
Ø160	DR451600016014	PN16	195	130	92	38	2,425	1
*Ø180	DR451600018017	PN16	222	152	105	47	4,160	1
*Ø200	DR451600020017	PN16	247	192	108	84	5,020	1
*Ø225	DR451600022517	PN16	273	160	120	40	6,750	1
*Ø250	DR451000025017	PN10	302	332	122	210	13,993	1
	DR451600025017	PN16	302	332	122	210	15,920	1
	DR451000028017	PN10	350	345	125	220	19,826	1
*Ø280	DR451600028017	PN16	350	345	125	220	22,665	1
*Ø315	DR451000031517	PN10	380	373	133	240	25,895	1
	DR451600031517	PN16	380	373	133	240	28,585	1
*Ø355	DR451000035517	PN10	410	360	129	231	26,780	1
	DR451600035517	PN16	425	360	129	231	36,046	1
*Ø400	DR451000040017	PN10	460	384	131	253	35,210	1
	DR451600040017	PN16	490	384	131	253	49,060	1
*Ø450	DR451000045017	PN10	510	471	162	309	55,060	1
	DR451600045017	PN16	555	471	162	309	78,882	1
*Ø500	DR451000050017	PN10	570	509	175	334	73,080	1
	DR451600050017	PN16	615	509	175	334	102,516	1
*Ø560	DR451000056017	PN10	640	441	175	266	80,940	1
	DR451600056017	PN16	685	441	175	266	121,760	1
*Ø630	DR451000063017	PN10	720	460	180	280	101,240	1
	DR451600063017	PN16	780	460	180	280	168,700	1

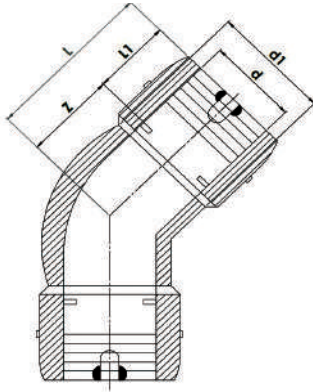

* İşareti olan ürünler KİT'tir./ *Products which marked are specially produced.

EF DİRSEK 90° EF ELBOW 90° ЭФ ОТВОД 90°

Elektrofüzyon / Electrofusion / Material:PE100 / Standart: TS EN 1555-3:2010 + A1 • TS EN 12201-3 + A1

d	Article No	Bar	d1	L	L1	Z	Weight (kg)	Pack (pc)
Ø20	DR901600002014	PN16	31	44	34	10	0,042	1
Ø25	DR901600002514	PN16	36	48	34	14	0,054	1
Ø32	DR901600003214	PN16	45	53	35	18	0,070	1
Ø40	DR901600004014	PN16	55	61	39	22	0,118	1
Ø50	DR901600005014	PN16	67	70	42	28	0,172	1
Ø63	DR901600006314	PN16	81	80	46	34	0,276	1
Ø75	DR901600007514	PN16	95	100	61	39	0,475	1
Ø90	DR901600009014	PN16	113	120	63	57	0,800	1
Ø110	DR901600011014	PN16	137	143	80	63	1,345	1
Ø125	DR901600012514	PN16	152	140	77	63	1,520	1
*Ø140	DR901000014017	PN10	163	278	83	195	3,240	1
	DR901600014017	PN16	163	278	83	195	3,778	1
Ø160	DR901600016014	PN16	195	171	93	78	2,920	1
*Ø180	DR901600018017	PN16	222	152	105	47	5,620	1
*Ø200	DR901600020017	PN16	246	215	104	110	5,500	1
*Ø225	DR901600022517	PN16	276	245	120	135	9,750	1
	DR901000025017	PN10	302	412	122	290	15,570	1
*Ø250	DR901600025017	PN16	302	412	122	290	17,960	1
	DR901000028017	PN10	350	425	125	300	21,720	1
*Ø280	DR901600028017	PN16	350	425	125	300	25,218	1
	DR901000031517	PN10	380	468	133	335	29,415	1
*Ø315	DR901600031517	PN16	380	468	133	335	34,256	1
	DR901000035517	PN10	410	474	129	345	31,880	1
*Ø355	DR901600035517	PN16	425	474	129	345	42,377	1
	DR901000040017	PN10	460	501	131	370	41,005	1
*Ø400	DR901600040017	PN16	490	501	131	370	57,605	1
	DR901000031517	PN10	510	607	162	445	62,960	1
*Ø450	DR901600031517	PN16	555	607	162	445	89,762	1
	DR901000031517	PN10	570	660	175	485	84,180	1
*Ø500	DR901600031517	PN16	615	660	175	485	117,516	1
	DR901000031517	PN10	640	968	175	793	126,468	1
*Ø560	DR901600031517	PN16	685	968	175	793	190,648	1
	DR901000031517	PN10	720	1008	180	828	160,810	1
*Ø630	DR901600031517	PN16	780	1008	180	828	258,234	1

* İşareti olan ürünler KİT'tir./ *Products which marked are specially produced.

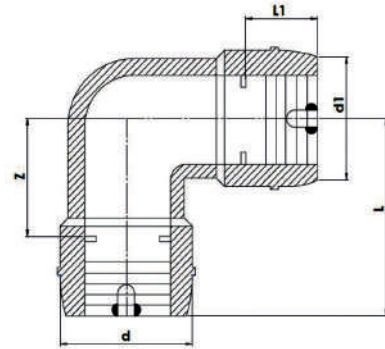

EF EŞİT TE 90° EF EQUAL TEE 90° ЭФ ТРОЙНИК 90°

Elektrofüzyon / Electrofusion / Material:PE100 / Standart: TS EN 1555-3:2010 + A1 • TS EN 12201-3 + A1

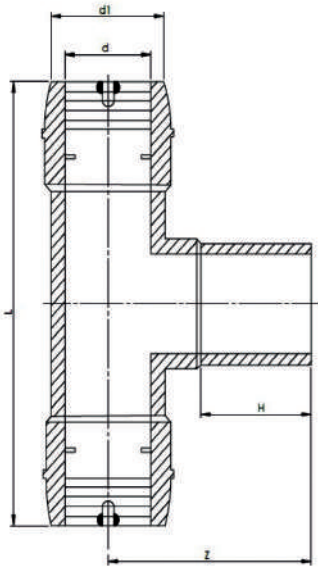

d	Article No	Bar	d1	L	L1	Z	Weight (kg)	Pack (pc)
*Ø20	TE001600002017	PN16	31	213	50	75	0,097	1
*Ø25	TE001600002517	PN16	36	226	50	80	0,126	1
Ø32	TE001600003214	PN16	43	103	40	67	0,087	1
Ø40	TE001600004014	PN16	54	120	46	77	0,140	1
Ø50	TE001600005014	PN16	65	135	49	87	0,220	1
Ø63	TE001600006314	PN16	78	150	55	100	0,323	1
Ø75	TE001600007514	PN16	92	183	66	120	0,565	1
Ø90	TE001600009014	PN16	110	201	76	140	0,865	1
Ø110	TE001600011014	PN16	135	251	85	161	1,550	1
Ø125	TE001600012514	PN16	151	253	88	173	1,870	1
Ø140	TE001600014014	PN16	170	283	98	187	2,300	1
Ø160	TE001600016014	PN16	193	322	98	205	3,695	1
*Ø180	TE001600018017	PN16	211	606	105	225	7,690	1
*Ø200	TE001600020017	PN16	230	655	115	250	10,110	1
Ø225	TE001600022514	PN16	256	658	116	253	12,100	1
*Ø250	TE001000025017	PN10	302	794	130	275	17,795	1
	TE001600025017	PN16	302	794	130	275	20,090	1
*Ø280	TE001000028017	PN10	350	840	145	290	24,420	1
	TE001600028017	PN16	350	840	145	290	27,905	1
*Ø315	TE001000031517	PN10	380	935	155	325	33,285	1
	TE001600031517	PN16	380	935	155	325	38,400	1
*Ø355	TE001000035517	PN10	410	988	155	360	37,807	1
	TE001600035517	PN16	410	988	155	360	45,785	1
*Ø400	TE001000040017	PN10	460	1050	155	395	50,550	1
	TE001600040017	PN16	490	1045	155	395	68,940	1
*Ø450	TE001000045017	PN10	510	1213	175	445	76,000	1
	TE001600045017	PN16	555	1213	175	445	107,882	1
*Ø500	TE001000050017	PN10	570	1350	250	500	91,356	1
	TE001600050017	PN16	615	1350	250	500	130,895	1
*Ø560	TE001000056017	PN10	640	1410	250	530	113,424	1
	TE001600056017	PN16	685	1410	250	530	170,994	1
*Ø630	TE001000063017	PN10	720	1490	250	565	143,988	1
	TE001600063017	PN16	780	1490	250	565	232,867	1

* İşareti olan ürünler KİT'tir. / *Products which marked are specially produced.
2 tarafı ayrı ayrı kaynatılabilir. / 2 side separate fusion zone.

EF İNEGAL TE 90° EF REDUCED TEE 90° ЭФ ТРОЙНИК-ПЕРЕХОДНИК 90°

Elektrofüzyon / Electrofusion / Material:PE100 / Standart: TS EN 1555-3:2010 + A1 • TS EN 12201-3 + A1

d-d2	Article No	Bar	d1	L	L1	Z	Weight (kg)	Pack (pc)
*Ø25-20	TE001600502517	PN16	36	226	35	110	0,131	1
*Ø32-20	TE001600502517	PN16	43	237	35	105	0,179	1
*Ø32-25	TE001600502517	PN16	43	237	55	80	0,174	1
Ø40-20	TE001600502514	PN16	53	120	35	67	0,135	1
Ø40-25	TE001600502514	PN16	53	120	39	71	0,138	1
Ø40-32	TE001600502514	PN16	53	120	45	77	0,140	1
Ø50-20	TE001600502014	PN16	64	134	35	73	0,208	1
Ø50-25	TE001600502514	PN16	64	134	39	77	0,214	1
Ø50-32	TE001600503214	PN16	64	134	43	81	0,218	1
Ø50-40	TE001600504014	PN16	64	134	48	86	0,220	1
Ø63-20	TE001600632014	PN16	79	134	37	87	0,262	1
Ø63-25	TE001600632514	PN16	79	134	40	90	0,267	1
Ø63-32	TE001600633214	PN16	78	135	46	95	0,265	1
Ø63-40	TE001600634014	PN16	77	134	55	100	0,250	1
Ø63-50	TE001600635014	PN16	78	151	54	98	0,330	1
Ø75-32	TE001600753214	PN16	92	185	45	100	0,520	1
Ø75-40	TE001600754014	PN16	92	185	45	100	0,540	1
Ø75-50	TE001600755014	PN16	92	185	45	100	0,535	1
*Ø75-63	TE001600756317	PN16	95	375	60	115	1,040	1
Ø90-20	TE001600902014	PN16	115	193	60	120	0,640	1
Ø90-25	TE001600902514	PN16	115	193	63	124	0,645	1
Ø90-32	TE001600903214	PN16	115	193	65	126	0,655	1
Ø90-40	TE001600904014	PN16	115	193	67	128	0,670	1
Ø90-50	TE001600905014	PN16	115	193	67	128	0,700	1
Ø90-63	TE001600906314	PN16	115	193	67	128	0,730	1
Ø90-75	TE001600907514	PN16	115	193	67	128	0,750	1
*Ø110-20	TE001601102017	PN16	133	393	35	150	1,959	1
*Ø110-25	TE001601102517	PN16	133	393	55	125	1,954	1
*Ø110-32	TE001601103217	PN16	133	393	60	135	1,962	1
Ø110-40	TE001601104014	PN16	139	227	68	143	1,260	1
Ø110-50	TE001601105014	PN16	137	225	67	149	1,267	1
Ø110-63	TE001601106314	PN16	135	225	66	147	1,270	1
*Ø110-75	TE001601107517	PN16	133	459	70	142	2,250	1
Ø110-90	TE001601109014	PN16	137	253	84	162	1,600	1
*Ø125-50	TE001601255017	PN16	152	517	45	167	3,272	1
*Ø125-63	TE001601256317	PN16	152	517	60	140	3,220	1
*Ø125-75	TE001601257517	PN16	152	517	65	202	3,389	1
Ø125-90	TE001601259014	PN16	151	255	86	175	1,896	1
Ø125-110	TE001612511014	PN16	151	255	86	171	1,900	1
Ø140-90	TE001601409014	PN16	170	283	85	174	2,000	1
Ø140-110	TE001614011014	PN16	170	283	85	174	2,100	1
Ø140-125	TE001614012514	PN16	170	283	95	184	2,200	1
Ø160-50	TE001601605014	PN16	195	275	61	187	2,600	1
Ø160-63	TE001601606314	PN16	195	275	61	187	2,655	1

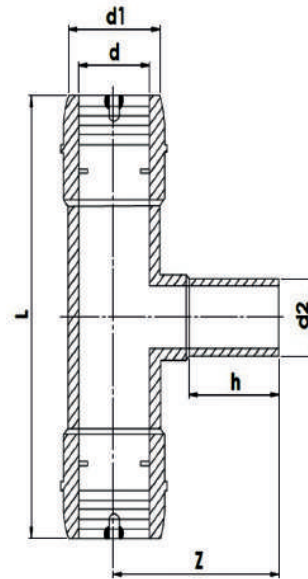

EF İNEGAL TE 90° EF REDUCED TEE 90° ЭФ ТРОЙНИК-ПЕРЕХОДНИК 90°

Elektrofüzyon / Electrofusion / Material:PE100 / Standart: TS EN 1555-3:2010 + A1 • TS EN 12201-3 + A1

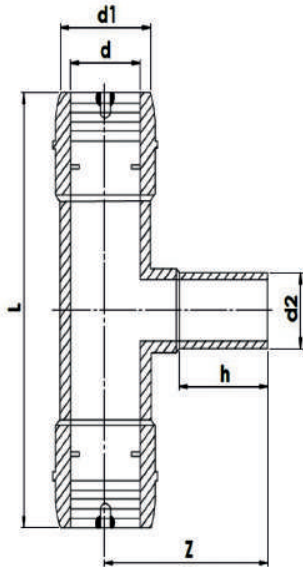

d-d2	Article No	Bar	d1	L	L1	Z	Weight (kg)	Pack (pc)
*Ø160-75	TE001601607517	PN16	195	495	70	165	5,075	1
Ø160-90	TE001601609014	PN16	195	275	84	197	2,720	1
Ø160-110	TE001616011014	PN16	195	277	85	196	2,555	1
Ø160-125	TE001616012514	PN16	195	280	90	205	2,830	1
Ø160-140	TE001616014014	PN16	195	280	90	205	2,900	1
*Ø180-90	TE001601809017	PN16	211	606	95	455	6,648	1
*Ø180-110	TE001618011017	PN16	211	606	99	455	6,865	1
*Ø180-125	TE001618012517	PN16	211	606	100	455	6,800	1
*Ø180-160	TE001618016017	PN16	211	606	105	455	7,000	1
*Ø200-63	TE001602006317	PN16	230	655	63	495	8,790	1
*Ø200-75	TE001602007517	PN16	230	655	78	495	9,100	1
*Ø200-90	TE001602009017	PN16	230	655	80	495	9,137	1
*Ø200-110	TE001620011017	PN16	230	655	82	495	9,180	1
*Ø200-125	TE001620012517	PN16	230	655	95	495	9,150	1
*Ø200-140	TE001620014017	PN16	230	655	98	495	9,500	1
*Ø200-160	TE001620016017	PN16	230	655	102	495	9,680	1
*Ø200-180	TE001620018017	PN16	230	655	110	495	10,162	1
*Ø225-110	TE001622511017	PN16	256	658	85	515	10,621	1
*Ø225-160	TE001622516017	PN16	256	658	100	515	11,157	1
*Ø225-200	TE001622520017	PN16	256	658	110	515	11,600	1
*Ø250-90	TE001002509017	PN10	302	669	82	220	14,400	1
	TE001602509017	PN16	302	669	82	220	17,050	1
*Ø250-110	TE001025011017	PN10	302	694	83	240	14,270	1
	TE001625011017	PN16	302	694	83	240	16,610	1
*Ø250-125	TE001025012517	PN10	302	699	97	260	14,600	1
	TE001625012517	PN16	302	699	97	260	17,050	1
*Ø250-140	TE001025014017	PN10	302	694	93	240	14,330	1
	TE001625014017	PN16	302	699	85	320	17,276	1
*Ø250-160	TE001025016017	PN10	302	694	100	260	14,530	1
	TE001625016017	PN16	302	694	100	260	17,020	1
*Ø250-180	TE001025018017	PN10	302	799	90	295	17,401	1
	TE001625018017	PN16	302	799	95	305	19,711	1
*Ø280-110	TE001028011017	PN10	350	720	85	250	20,980	1
	TE001628011017	PN16	350	710	85	250	23,765	1
*Ø280-125	TE001028012517	PN10	350	710	80	295	23,078	1
	TE001628012517	PN16	350	710	80	300	24,175	1
*Ø280-160	TE001028016017	PN10	350	710	98	260	22,960	1
	TE001628016017	PN16	350	710	98	260	24,035	1
*Ø315-90	TE001003159017	PN10	380	775	87	304	26,442	1
	TE001603159017	PN16	380	775	80	302	30,041	1
*Ø315-110	TE001031511017	PN10	380	775	80	265	26,345	1
	TE001631511017	PN16	380	775	80	265	29,907	1
*Ø315-125	TE001031512517	PN10	380	775	80	312	26,381	1
	TE001631512517	PN16	380	775	80	312	30,777	1
*Ø315-160	TE001031516017	PN10	380	775	100	290	26,150	1
	TE001631516017	PN16	380	780	100	295	30,650	1
*Ø315-180	TE001031518017	PN10	380	775	90	327	26,820	1
	TE001631518017	PN16	380	775	95	337	31,117	1

EF İNEGAL TE 90° EF REDUCED TEE 90° ЭФ ТРОЙНИК-ПЕРЕХОДНИК 90°

Elektrofüzyon / Electrofusion / Material:PE100 / Standart: TS EN 1555-3:2010 + A1 • TS EN 12201-3 + A1

d-d2	Article No	Bar	d1	L	L1	Z	Weight (kg)	Pack (pc)
*Ø315-200	TE001031520017	PN10	380	775	120	310	26,600	1
	TE001631520017	PN16	380	775	120	305	30,750	1
*Ø315-225	TE001031522517	PN10	380	935	110	315	30,600	1
	TE001631522517	PN16	380	930	125	392	37,063	1
*Ø315-250	TE001031525017	PN10	380	930	125	315	31,485	1
	TE001631525017	PN16	380	930	125	315	36,070	1
*Ø355-110	TE001035511017	PN10	410	688	85	290	26,900	1
	TE001635511017	PN16	428	688	85	290	35,506	1
*Ø355-125	TE001035512517	PN10	410	688	80	332	27,439	1
	TE001635512517	PN16	428	688	80	337	36,290	1
*Ø355-250	TE001035525017	PN10	410	838	150	327	31,500	1
	TE001635525017	PN16	428	838	150	327	42,266	1
*Ø400-250	TE001040025017	PN10	460	891	150	350	40,500	1
	TE001640025017	PN16	489	891	150	350	56,130	1
*Ø450-90	TE001004509017	PN10	510	1213	85	830	79,505	1
	TE001604509017	PN16	557	1213	85	810	110,534	1
*Ø450-125	TE001045012517	PN10	510	1213	95	785	79,408	1
	TE001645012517	PN16	557	1213	85	745	110,526	1
*Ø450-180	TE001045018017	PN10	510	1213	90	755	79,502	1
	TE001645018017	PN16	557	1213	90	735	110,829	1
*Ø450-225	TE001045022517	PN10	510	1213	115	770	80,807	1
	TE001645022517	PN16	557	1213	115	795	121,535	1
*Ø450-315	TE001045031517	PN10	510	1213	130	670	80,021	1
	TE001645031517	PN16	557	1213	140	705	114,685	1

* İşareti olan ürünler KİT'tir. / *Products which marked are specially produced.
2 tarafı ayrı ayrı kaynatılabilir. / 2 side seperate fusion zone.

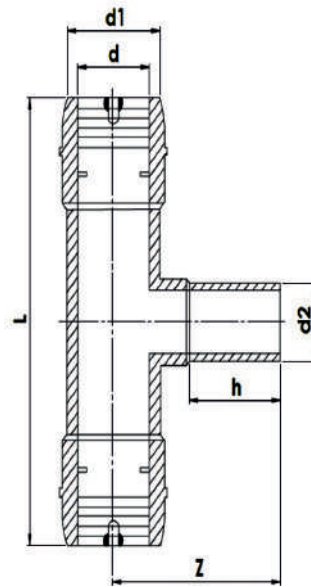

EF REDÜKSİYON EF REDUCER ЭФ ПЕРЕХОДНИК

Elektrofüzyon / Electrofusion / Material: PE100 / Standart: TS EN 1555-3:2010 + A1 • TS EN 12201-3 + A1

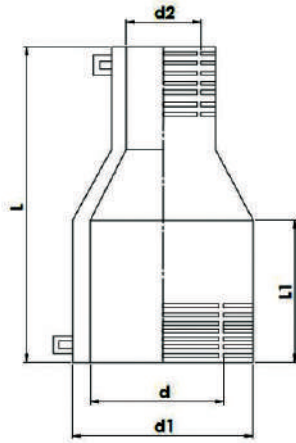

d-d2	Article No	Bar	d1	L	L1	Weight (kg)	Pack (pc)
*Ø25-20	RD001600252017	PN16	36	150	76	0,084	1
*Ø32-20	RD001600322017	PN16	43	180	86	0,111	1
*Ø32-25	RD001600322517	PN16	43	187	91	0,121	1
*Ø40-20	RD001600402017	PN16	53	179	85	0,136	1
*Ø40-25	RD001600402517	PN16	53	181	85	0,146	1
*Ø40-32	RD001600403217	PN16	53	181	85	0,162	1
*Ø50-25	RD001600502517	PN16	65	189	89	0,199	1
*Ø50-32	RD001600503217	PN16	65	195	89	0,221	1
*Ø50-40	RD001600504017	PN16	65	224	114	0,277	1
*Ø63-20	RD001600632017	PN16	80	200	98	0,273	1
*Ø63-25	RD001600632517	PN16	80	203	98	0,303	1
Ø63-32	RD001600633214	PN16	78	106	55	0,155	1
Ø63-40	RD001600634014	PN16	78	107	51	0,165	1
*Ø63-50	RD001600635017	PN16	80	206	98	0,382	1
*Ø75-20	RD001600752017	PN16	95	303	123	0,477	1
*Ø75-25	RD001600752517	PN16	95	305	123	0,486	1
*Ø75-32	RD001600753217	PN16	95	250	123	0,485	1
*Ø75-40	RD001600754017	PN16	95	250	125	0,522	1
*Ø75-50	RD001600755017	PN16	95	264	125	0,579	1
*Ø75-63	RD001600756317	PN16	95	263	120	0,660	1
*Ø90-32	RD001600903217	PN16	110	282	136	0,672	1
*Ø90-40	RD001600904017	PN16	110	341	141	0,775	1
*Ø90-50	RD001600905017	PN16	110	285	141	0,779	1
Ø90-63	RD001600906314	PN16	116	146	66	0,350	1
Ø90-75	RD001600907514	PN16	116	146	66	0,400	1
*Ø110-50	RD001001105017	PN10	133	305	162	0,989	1
	RD001601105017	PN16	133	305	162	1,071	1
Ø110-63	RD001601106314	PN16	135	161	77	0,602	1
*Ø110-75	RD001001107517	PN10	133	372	157	1,332	1
	RD001601107517	PN16	133	322	162	1,315	1
Ø110-90	RD001601109014	PN16	141	170	80	0,750	1
*Ø125-50	RD001001255017	PN10	152	395	169	1,435	1
	RD001601255017	PN16	152	377	169	1,493	1
Ø125-63	RD001601256314	PN16	150	180	85	0,694	1
*Ø125-75	RD001001257517	PN10	152	407	169	1,650	1
	RD001601257517	PN16	152	345	170	1,652	1
*Ø125-90	RD001001259017	PN10	152	353	169	1,641	1
	RD001601259017	PN16	152	353	169	1,820	1
*Ø125-110	RD001012511017	PN10	152	365	159	1,855	1
	RD001612511017	PN16	152	365	159	2,090	1
*Ø140-90	RD001001409017	PN10	163	424	178	2,040	1
	RD001601409017	PN16	163	354	178	2,090	1
*Ø140-110	RD001014011017	PN10	163	364	178	2,080	1
	RD001614011017	PN16	163	369	178	2,375	1
*Ø140-125	RD001014012517	PN10	163	371	178	2,380	1
	RD001614012517	PN16	163	376	178	2,650	1
*Ø160-63	RD001001606317	PN10	195	425	188	2,370	1
	RD001601606317	PN16	195	410	188	2,619	1

EF REDÜKSİYON

EF REDUCER

ЭФ ПЕРЕХОДНИК

Elektrofüzyon / Electrofusion / Material:PE100 / Standart: TS EN 1555-3:2010 + A1 • TS EN 12201-3 + A1

d-d2	Article No	Bar	d1	L	L1	Weight (kg)	Pack (pc)
*Ø160-75	RD001001607517	PN10	195	433	188	2,504	1
	RD001601607517	PN16	195	438	188	2,795	1
*Ø160-90	RD001001609017	PN10	195	369	188	2,480	1
	RD001601609017	PN16	195	379	188	2,815	1
Ø160-110	RD001616011014	PN16	191	221	93	1,734	1
*Ø160-125	RD001016012517	PN10	195	386	183	2,982	1
	RD001616012517	PN16	195	386	183	3,344	1
*Ø160-140	RD001016014017	PN10	195	395	183	3,115	1
	RD001616014017	PN16	195	395	183	3,560	1
*Ø180-110	RD001018011017	PN10	218	423	201	3,432	1
	RD001618011017	PN16	218	423	201	3,825	1
*Ø180-125	RD001018012517	PN10	218	425	201	3,717	1
	RD001618012517	PN16	218	425	201	4,195	1
*Ø180-140	RD001018014017	PN10	218	424	201	3,887	1
	RD001618014017	PN16	218	424	201	4,480	1
*Ø180-160	RD001018016017	PN10	218	434	201	4,453	1
	RD001618016017	PN16	218	434	201	5,100	1
*Ø200-63	RD001002006317	PN10	245	483	218	4,587	1
	RD001602006317	PN16	245	483	218	5,048	1
*Ø200-75	RD001002007517	PN10	245	483	218	4,789	1
	RD001602007517	PN16	245	483	218	5,186	1
*Ø200-90	RD001002009017	PN10	245	489	218	4,883	1
	RD001602009017	PN16	245	489	218	5,359	1
*Ø200-110	RD001020011017	PN10	245	440	218	4,945	1
	RD001620011017	PN16	245	440	218	5,380	1
*Ø200-125	RD001020012517	PN10	245	452	208	5,120	1
	RD001620012517	PN16	245	442	218	5,730	1
*Ø200-140	RD001020014017	PN10	245	446	223	5,240	1
	RD001620014017	PN16	245	446	223	5,780	1
*Ø200-160	RD001020016017	PN10	245	446	223	5,892	1
	RD001620016017	PN16	245	456	218	6,500	1
*Ø200-180	RD001020018017	PN10	245	449	223	6,380	1
	RD001620018017	PN16	245	454	218	7,145	1
*Ø225-110	RD001022511017	PN10	273	463	236	6,077	1
	RD001622511017	PN16	273	458	236	6,745	1
*Ø225-125	RD001022512517	PN10	273	470	236	6,291	1
	RD001622512517	PN16	273	535	231	7,502	1
*Ø225-140	RD001022514017	PN10	273	464	231	6,355	1
	RD001622514017	PN16	273	544	231	7,718	1
*Ø225-160	RD001022516017	PN10	273	464	236	7,127	1
	RD001622516017	PN16	273	469	231	7,845	1
*Ø225-180	RD001022518017	PN10	273	497	236	7,877	1
	RD001622518017	PN16	273	537	211	9,047	1
*Ø225-200	RD001022520017	PN10	273	484	231	8,880	1
	RD001622520017	PN16	273	484	211	9,730	1
*Ø250-75	RD001002507517	PN10	273	606	216	6,968	1
	RD001602507517	PN16	273	551	231	7,273	1

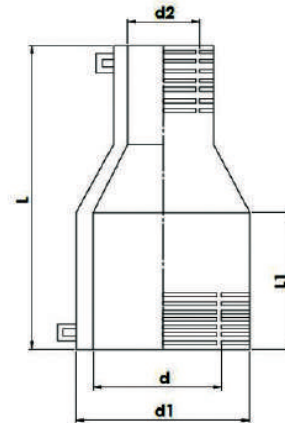

EF REDÜKSİYON EF REDUCER ЭФ ПЕРЕХОДНИК

Elektrofüzyon / Electrofusion / Material:PE100 / Standart: TS EN 1555-3:2010 + A1 • TS EN 12201-3 + A1

d-d2	Article No	Bar	d1	L	L1	Weight (kg)	Pack (pc)
*Ø250-160	RD001025016017	PN10	302	520	227	8,607	1
	RD001625016017	PN16	302	520	242	9,312	1
*Ø250-200	RD001025020017	PN10	302	535	227	10,358	1
	RD001625020017	PN16	302	530	242	11,597	1
*Ø250-225	RD001025022517	PN10	302	533	227	11,430	1
	RD001625022517	PN16	302	533	222	12,090	1
*Ø280-110	RD001028011017	PN10	350	612	265	11,093	1
	RD001628011017	PN16	350	607	265	12,303	1
*Ø280-140	RD001028014017	PN10	350	613	265	11,352	1
	RD001628014017	PN16	350	598	265	12,547	1
*Ø280-200	RD001028020017	PN10	350	568	265	13,287	1
	RD001628020017	PN16	350	553	265	14,595	1
*Ø280-225	RD001028022517	PN10	350	576	265	14,497	1
	RD001628022517	PN16	350	556	260	15,530	1
*Ø280-250	RD001028025017	PN10	350	567	260	15,480	1
	RD001628025017	PN16	350	572	260	16,802	1
*Ø315-160	RD001031516017	PN10	380	560	283	13,920	1
	RD001631516017	PN16	380	555	278	15,635	1
*Ø315-180	RD001031518017	PN10	380	619	278	14,845	1
	RD001631518017	PN16	380	639	283	16,858	1
*Ø315-200	RD001031520017	PN10	380	576	278	15,675	1
	RD001631520017	PN16	380	576	283	17,437	1
*Ø315-250	RD001031525017	PN10	380	585	278	17,250	1
	RD001631525017	PN16	380	580	278	19,685	1
*Ø315-280	RD001031528017	PN10	380	608	268	20,375	1
	RD001631528017	PN16	380	593	278	22,015	1
*Ø355-250	RD001035525017	PN10	410	616	289	18,740	1
	RD001635525017	PN16	428	611	284	23,688	1
*Ø355-280	RD001035528017	PN10	410	729	289	26,402	1
	RD001635528017	PN16	428	704	289	28,152	1
*Ø400-160	RD001040016017	PN10	460	663	271	19,153	1
	RD001640016017	PN16	489	658	271	24,739	1
*Ø400-250	RD001040025017	PN10	460	808	271	25,211	1
	RD001640025017	PN16	489	613	276	28,690	1
*Ø400-315	RD001040031517	PN10	460	623	271	26,310	1
	RD001640031517	PN16	489	638	251	34,512	1
*Ø400-355	RD001040035517	PN10	460	625	261	27,555	1
	RD001640035517	PN16	489	620	261	36,843	1
*Ø450-180	RD001045018017	PN10	510	848	312	31,441	1
	RD001645018017	PN16	557	838	312	42,695	1
*Ø450-315	RD001045031517	PN10	510	804	312	38,110	1
	RD001645031517	PN16	557	839	312	52,649	1
*Ø500-315	RD001050031517	PN10	570	888	325	48,250	1
	RD001650031517	PN16	615	923	325	67,926	1

*İşareti olan ürünler KİT'tir. / *The marked products are KIT

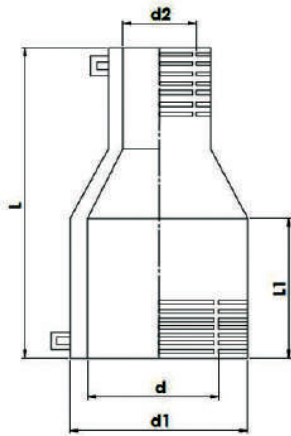

EF KEP EF END CAP ЭФ ЗАГЛУШКА

Elektrofüzyon / Electrofusion / Material:PE100 / Standart: TS EN 1555-3:2010 + A 1 • TS EN 12201-3 + A 1

d	Article No	Bar	d1	L	Weight (kg)	Pack (pc)
Ø20	KE001600002014	PN16	30	75	0,038	1
Ø25	KE001600002514	PN16	36	81	0,049	1
Ø32	KE001600003214	PN16	43	87	0,068	1
Ø40	KE001600004014	PN16	53	90	0,100	1
Ø50	KE001600005014	PN16	65	104	0,159	1
Ø63	KE001600006314	PN16	80	112	0,245	1
Ø75	KE001600007514	PN16	95	125	0,412	1
Ø90	KE001600009014	PN16	110	137	0,585	1
Ø110	KE001600011014	PN16	144	153	0,887	1
Ø125	KE001600012514	PN16	149	170	1,290	1
Ø140	KE001600014014	PN16	169	173	1,520	1
Ø160	KE001600016014	PN16	191	189	2,198	1
Ø180	KE001600018014	PN16	217	201	3,072	1
Ø200	KE001600020014	PN16	241	212	4,509	1
Ø225	KE001600022514	PN16	276	231	5,857	1
Ø250	KE001600025014	PN16	301	245	7,274	1
Ø280	KE001600028014	PN16	348	256	10,506	1
Ø315	KE001600031514	PN16	382	277	13,750	1
Ø355	KE001600035514	PN16	428	279	17,489	1
Ø400	KE001600040014	PN16	489	276	23,747	1

